

Vent tray ventilation option (kit no. 93540)

Detail A. Air inlet grille
Cut-out in cabinet floor

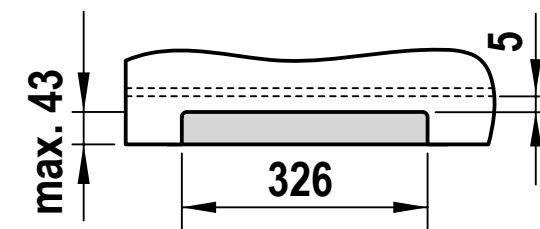

Detail B. Vent Tray air outlet
Cut-out in cabinet floor

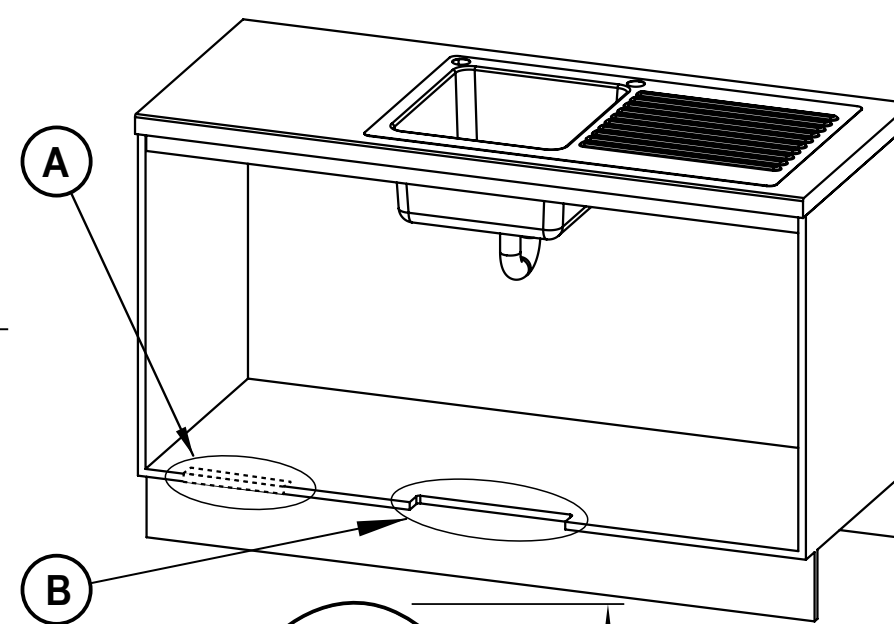
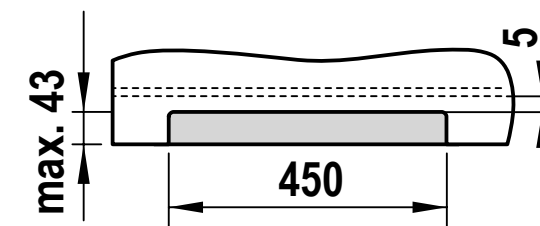

Tap Positioning

Position the Tap to dispense into the sink, allowing clearance for a cup or teapot. Alternatively, mount tap on a Font (available as an accessory).

Ø35mm hole for
Classic Tap

Sink shown only

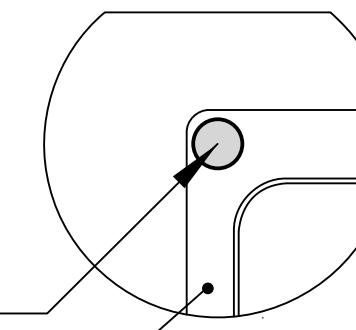

Touch-Free Wave Tap with 100mm extension & Font

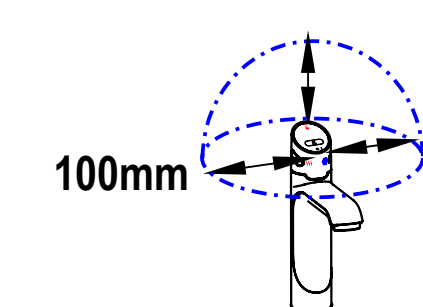
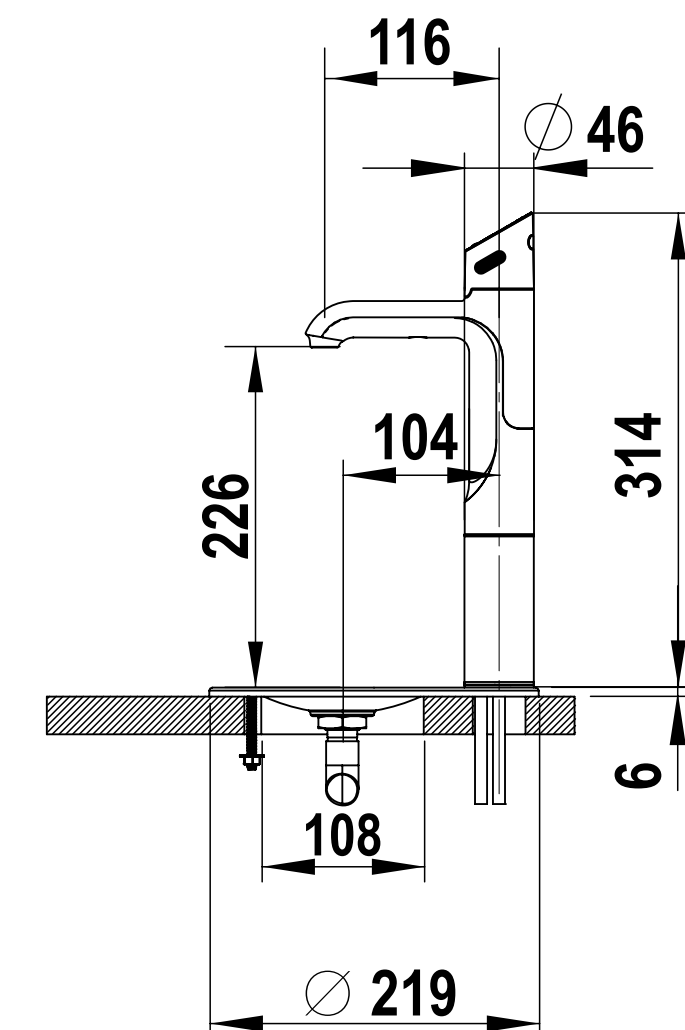

100mm clearance envelope required.
For Sink installations, install on the
left-hand side of the Sink for ease of
access to Boiling water function.

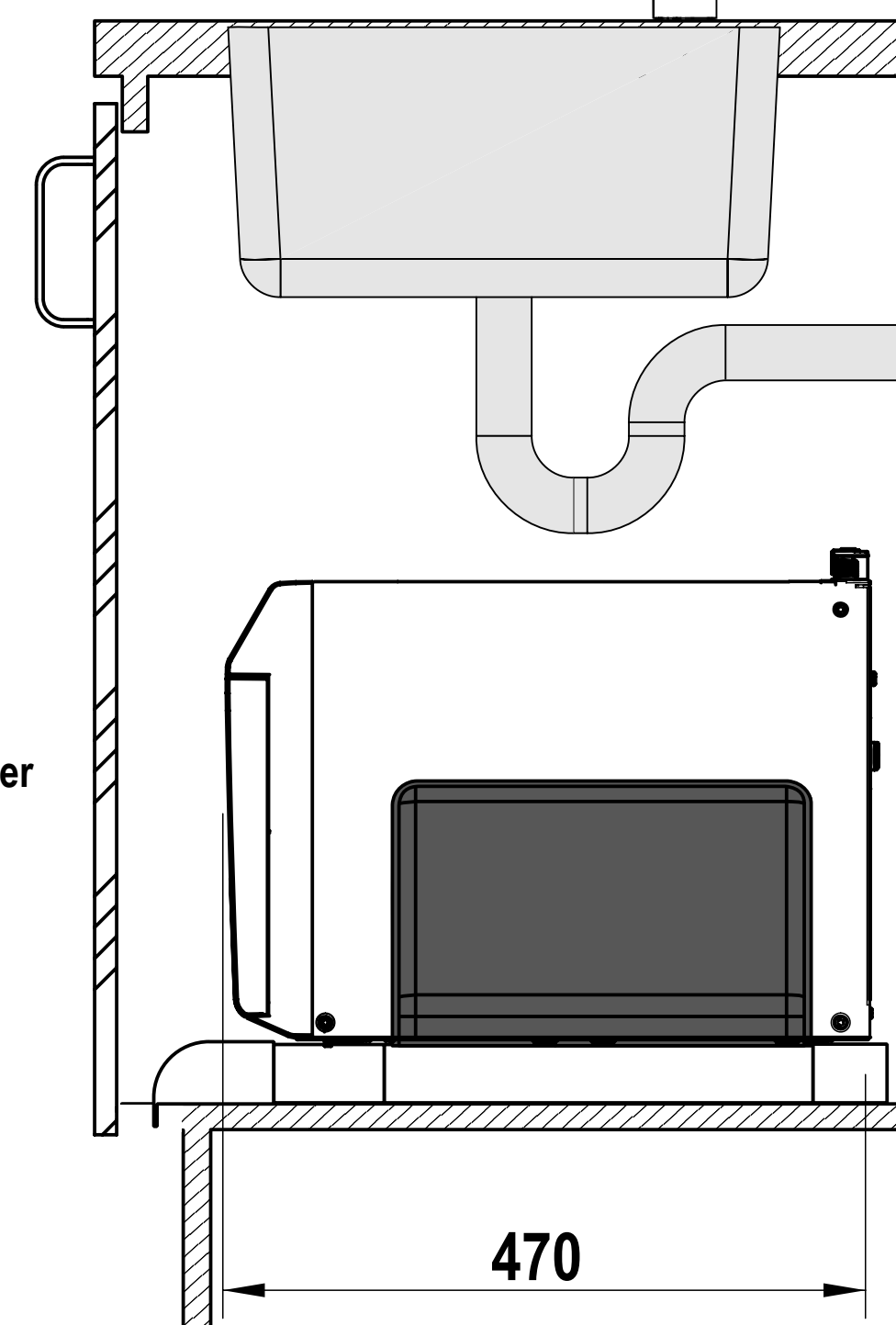
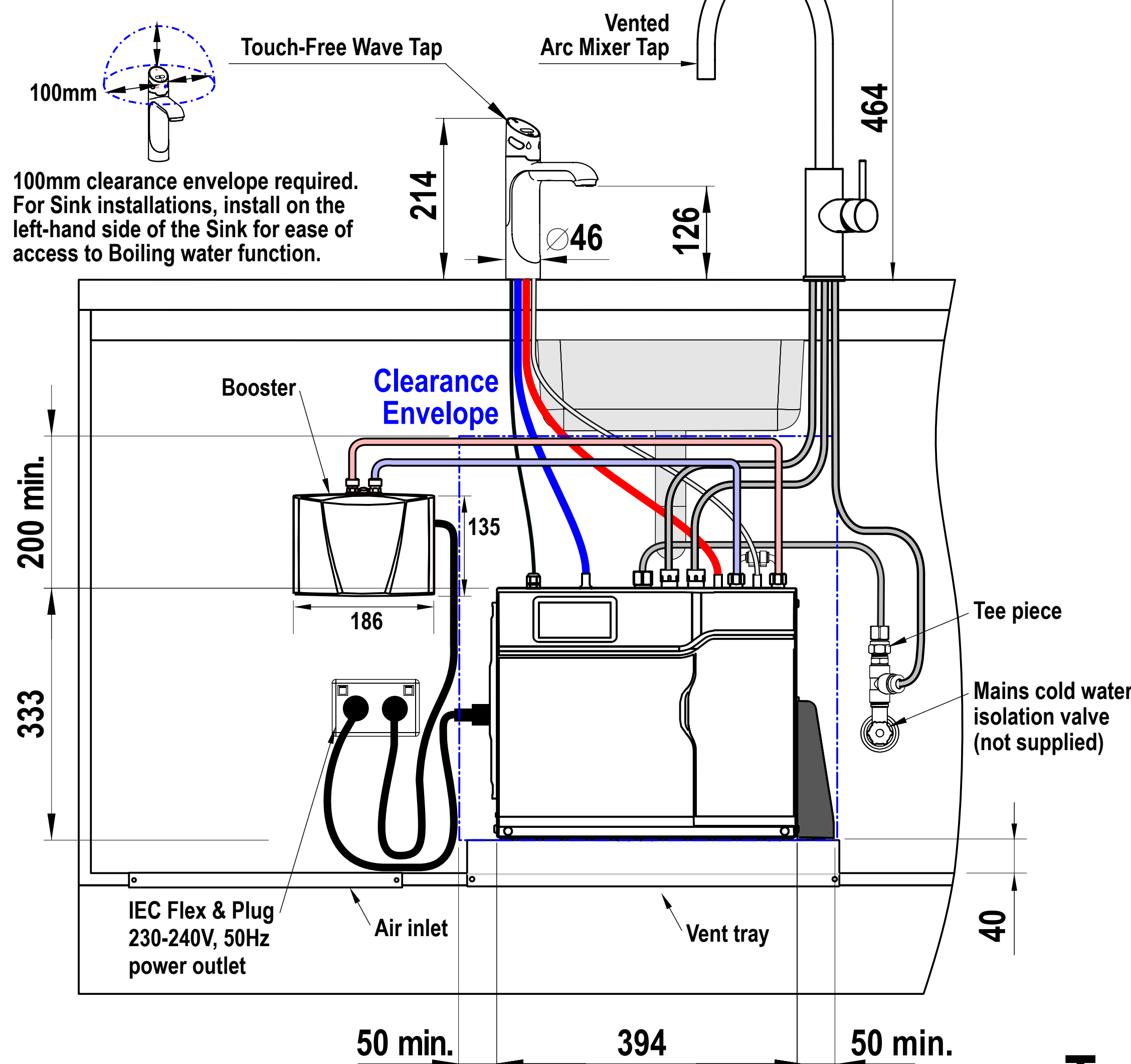

Cutting detail

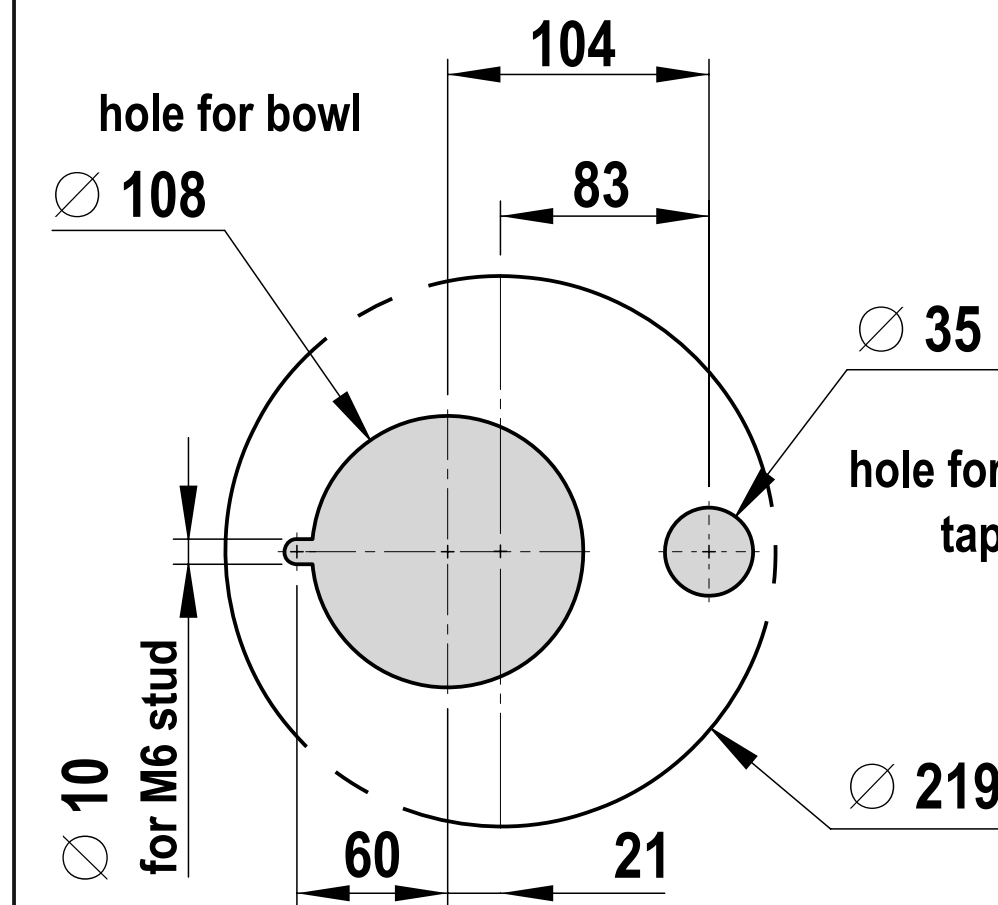

**HydroTap
BCH240/175**

Touch-Free Wave Tap with Arc Mixer Tap (V)