

Vent tray ventilation option (kit no. 93540)

Detail A. Air inlet grille
Cut-out in cabinet floor

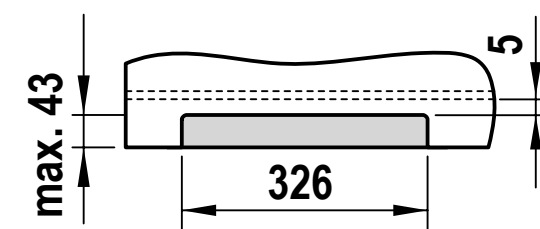

Detail B. Vent Tray air outlet
Cut-out in cabinet floor

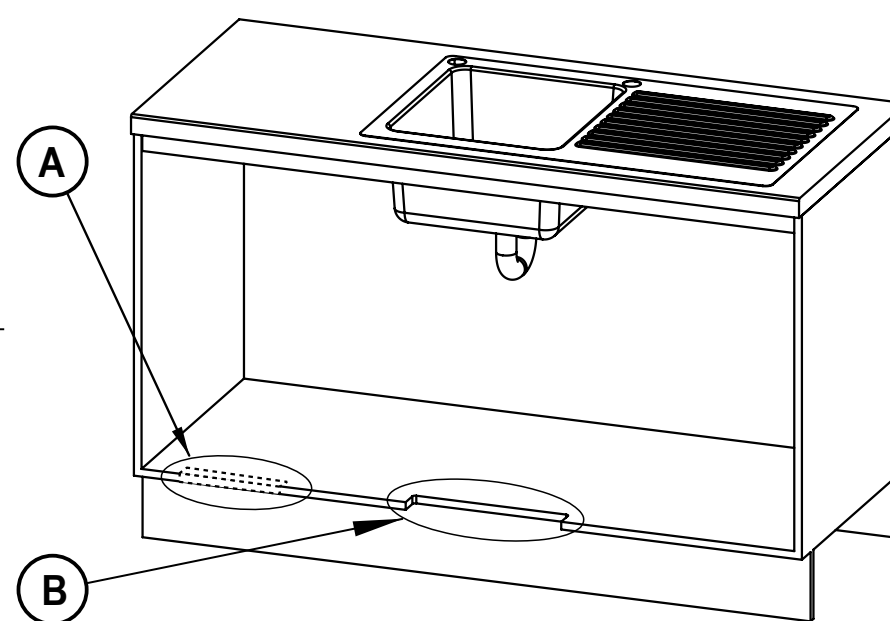
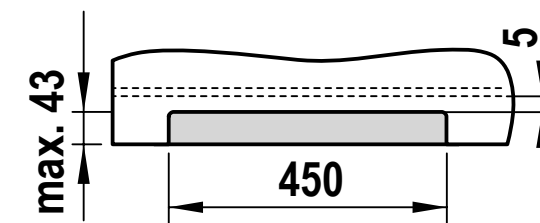

Tap Positioning

Install tap within 300mm of the benchtop edge to meet DDA accessibility requirements.
Font installation is preferred.
For Sink installations, install on the left-hand side of the Sink for ease of access to Boiling water function.

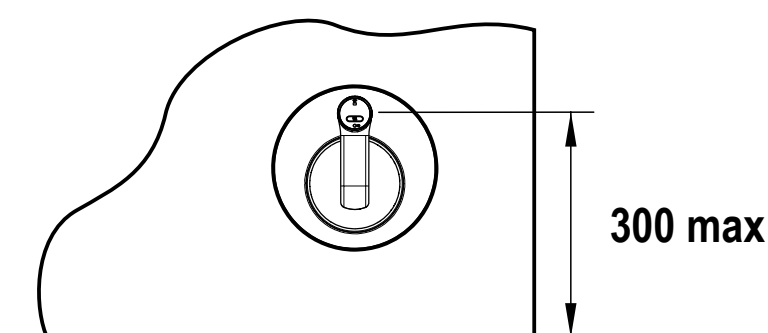

Touch-Free Wave Tap with 100mm extension & Font

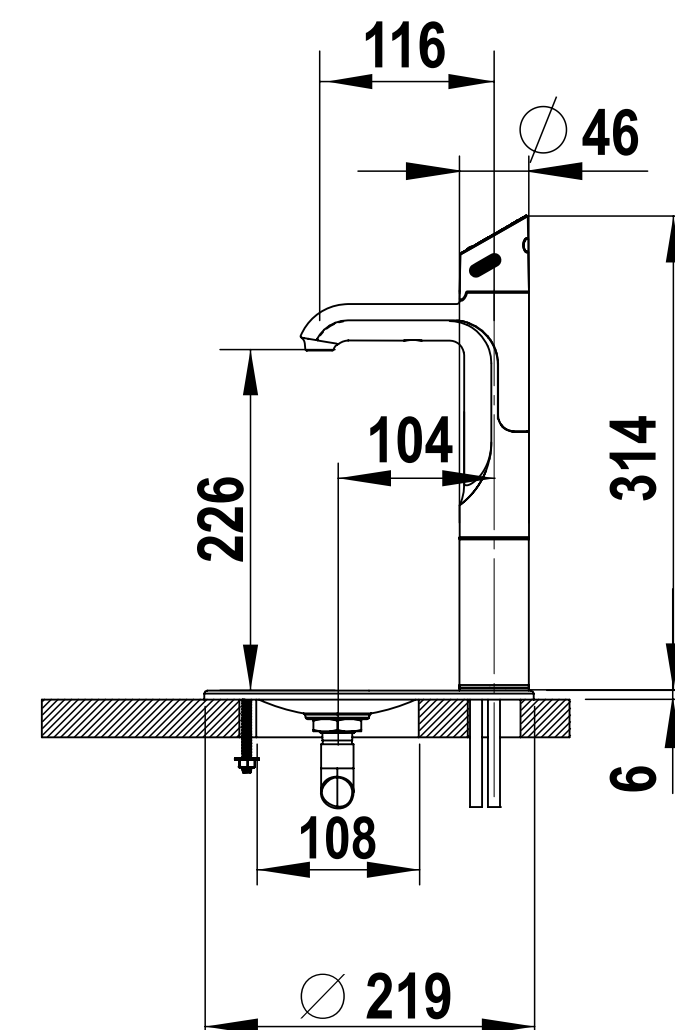

Touch-Free Wave Tap

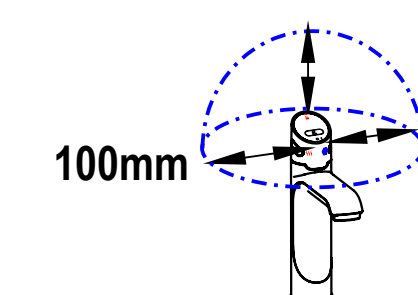

100mm clearance envelope required.

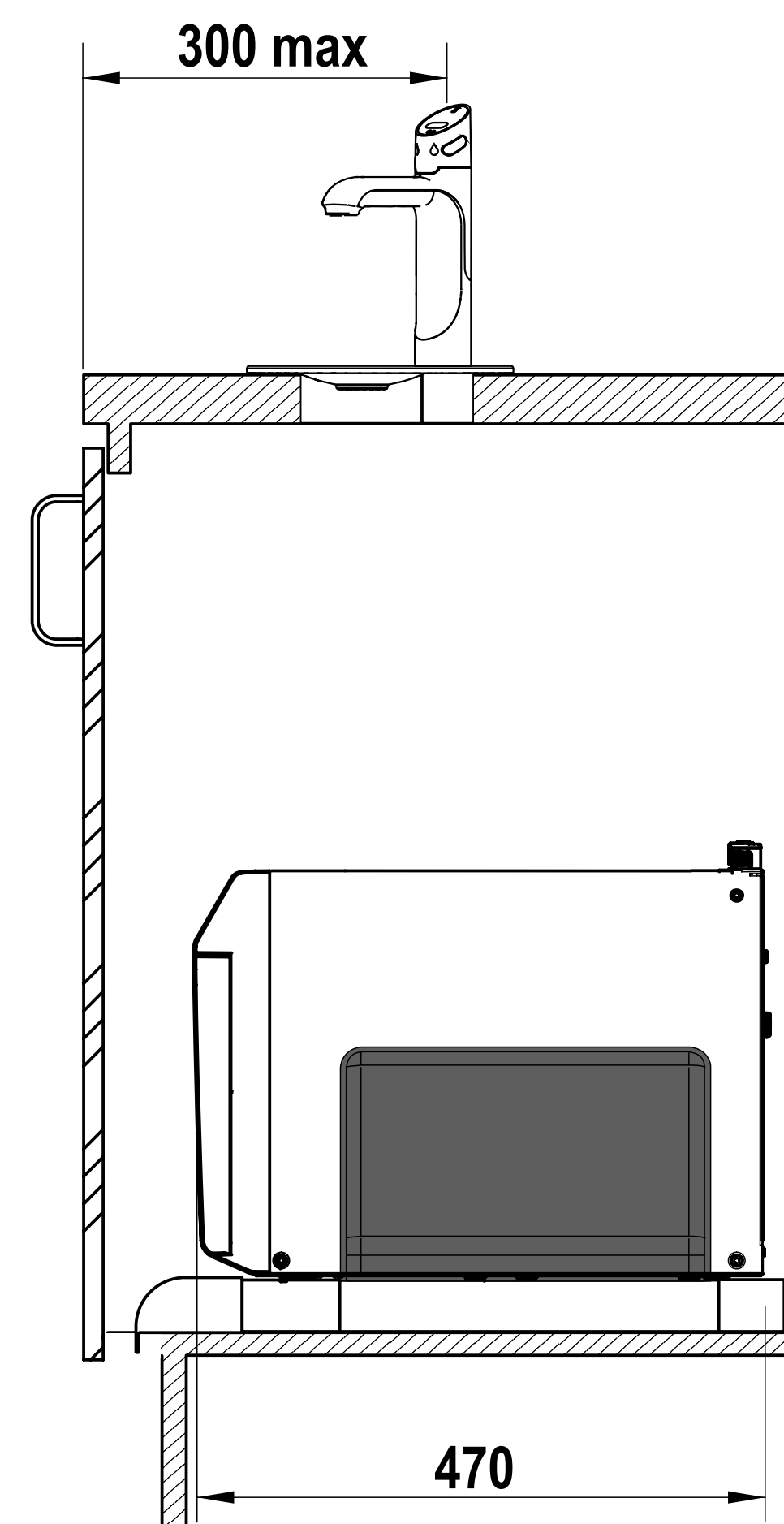
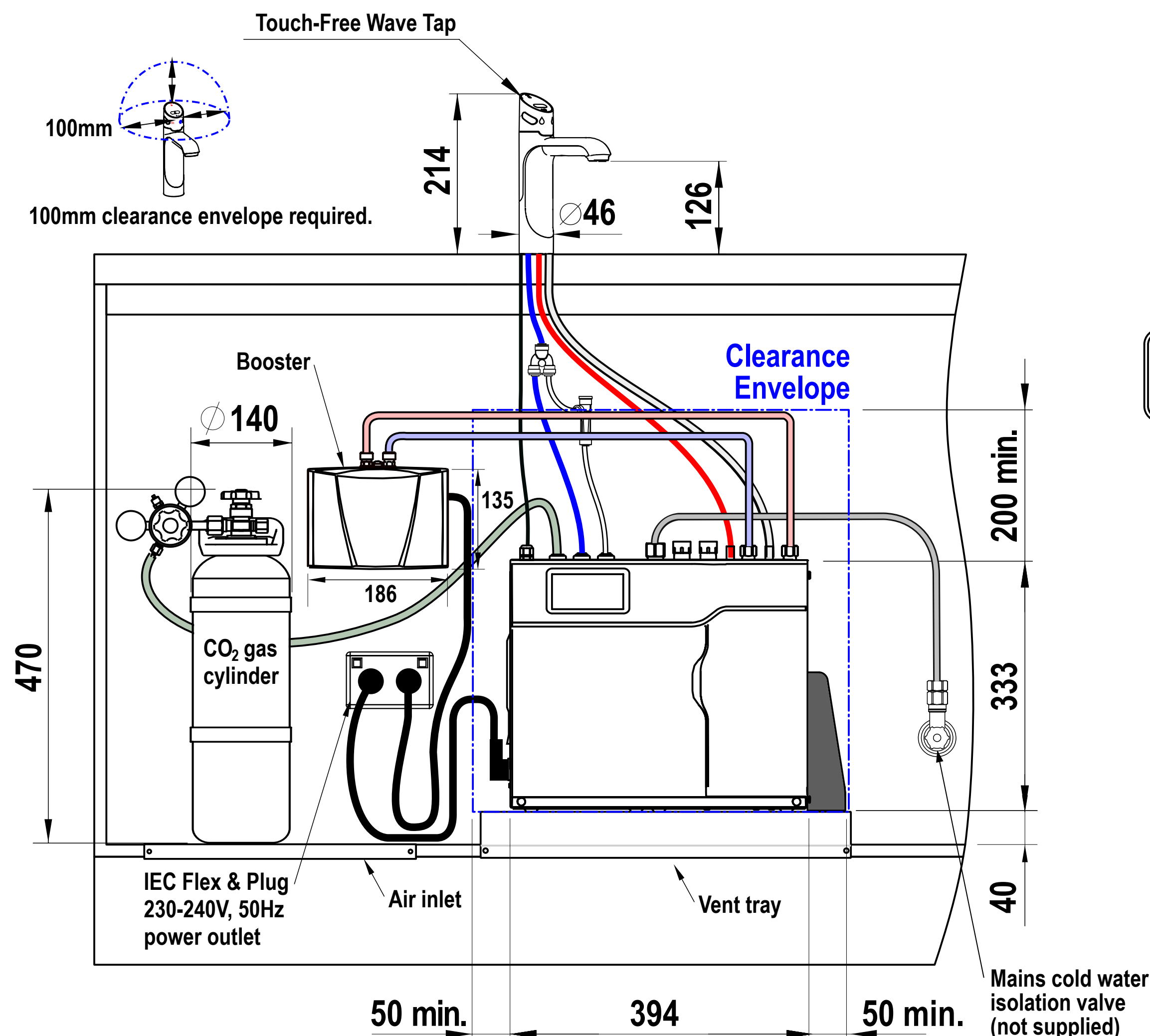

Cutting detail

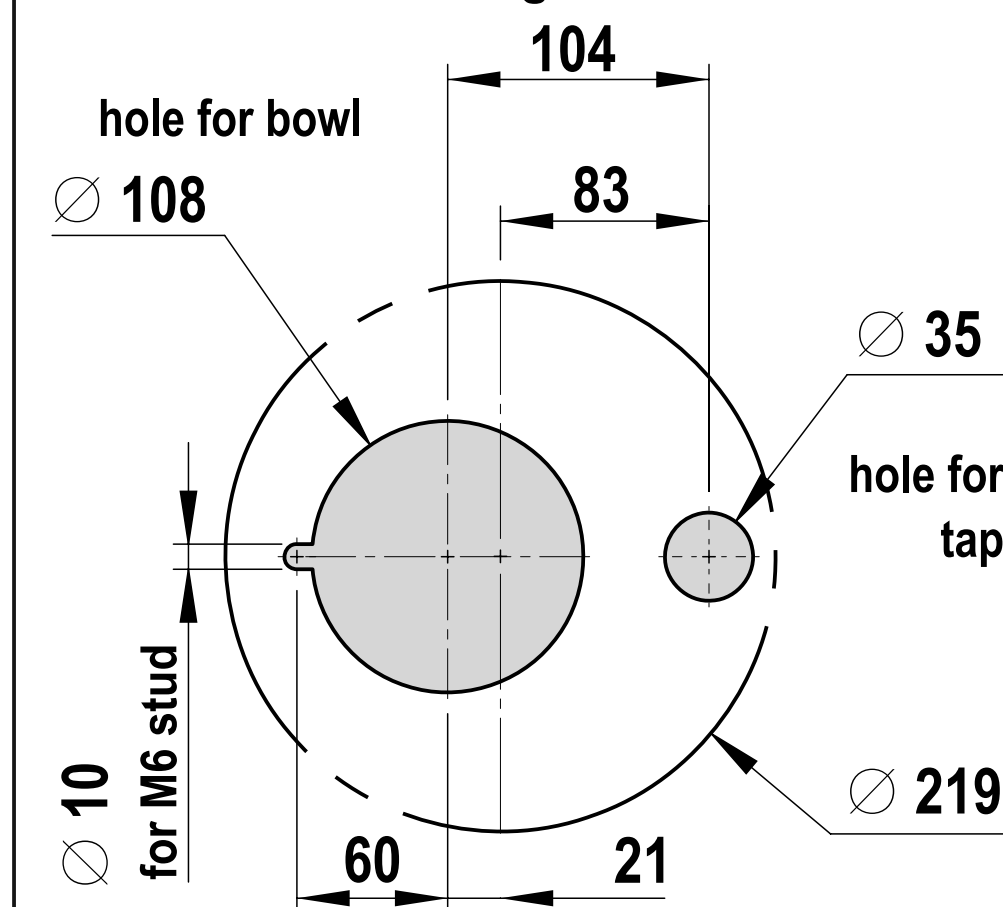

HydroTap BCS240/175

with Touch-Free Wave Tap

SCALE 1:5

ALL DIMENSIONS IN MM UNLESS OTHERWISE SPECIFIED